

PLAN VIEW
SCALE 1/2" = 1'-0"

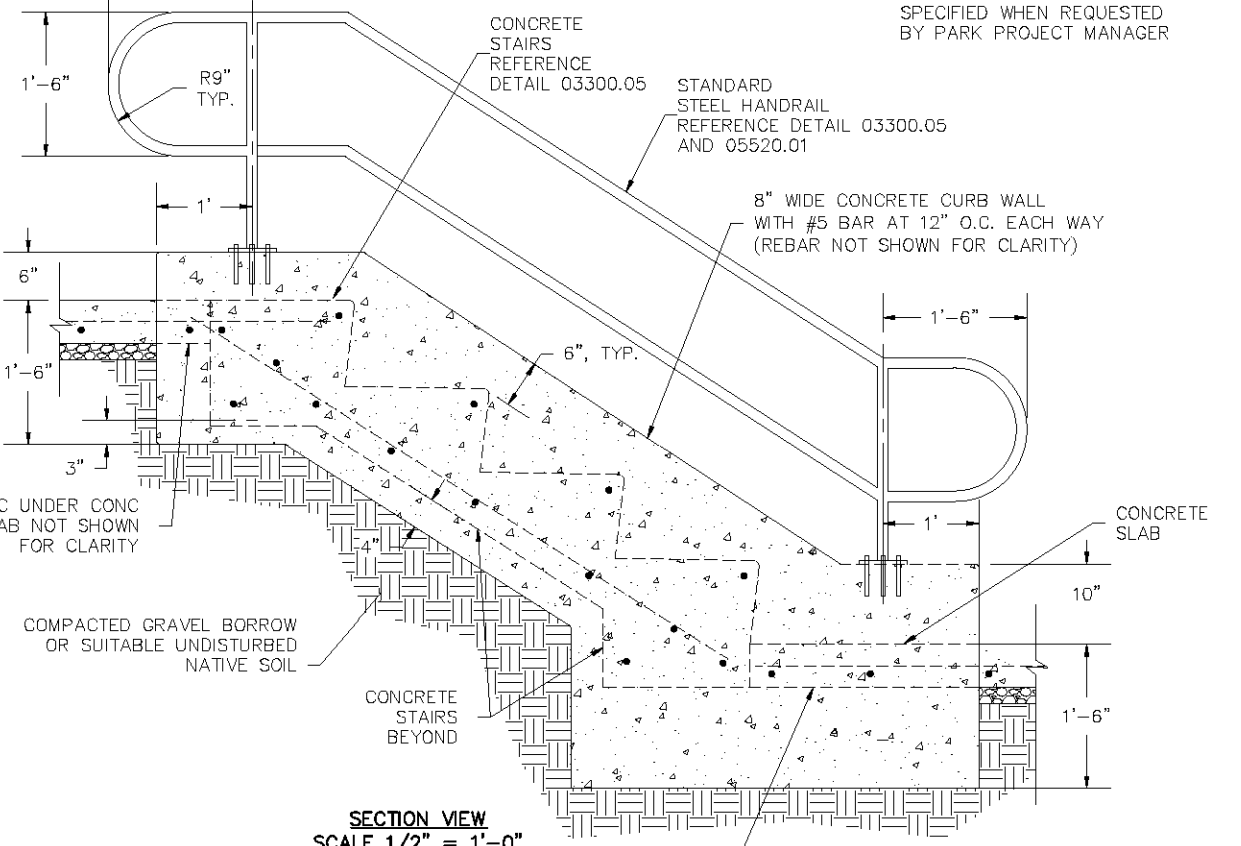

SECTION VIEW
SCALE 1/2" = 1'-0"

NOTES:

- A. USE OF THIS DETAIL MAY NOT BE SUITABLE FOR ALL SITES AND MUST BE PREAPPROVED BY THE PARK PROJECT MANAGER.
- B. CONCRETE SHALL BE MEDIUM BROOM FINISH. BROOM FINISH SHALL BE PERPENDICULAR TO THE PATH OF TRAVEL.
- C. CONCRETE MIX DESIGN SHALL MEET WSDOT STANDARD SPECIFICATIONS, LATEST EDITION
- D. NUMBER OF STEPS SHALL SUIT INDIVIDUAL CONDITIONS WITH UNIFORM TREAD AND RISER DIMENSIONS TO MEET REQUIREMENTS OF INTERNATIONAL BUILDING CODE, LATEST EDITION. THE MINIMUM TREAD DEPTH SHALL BE 12 INCHES
- E. STEP WIDTH SHALL MATCH WIDTH OF WALKWAY, BUT SHALL BE NO LESS THAN 4'-0" WIDE
- F. PROVIDE LANDINGS AS REQUIRED BY INTERNATIONAL BUILDING CODE, LATEST EDITION
- G. REINFORCING STEEL SHALL BE ASTM A615 GR 60
- H. TREAD SLOPES OUTWARD @1% IN DIRECTION OF TRAVEL
- I. REPAIR OF GALVANIZED COATINGS SHALL IN ACCORDANCE WITH ASTM A 780 - 01

**PARKS AND RECREATION
DESIGN AND DEVELOPMENT
FEBRUARY 23, 2011**

**CITY OF BELLINGHAM
CAST-IN-PLACE
CONCRETE STAIR WITH
CONCRETE CURB WALL**

**DRAWING
03300.06**