

## Carl Lobe Playground

### Photographs



### Description

Tot lot renovation including demolition of the existing playground, erosion and pedestrian circulation control, drainage and accessibility improvements, construction of a new playground including new fall surfacing and a new bike rack.

### Funding

\$61,300.00 in Real Estate Excise Tax

### Status

Complete

### Reference

- [Carl Lobe Tot Lot layout \(PDF\)](#)

- NOTES:
1. STAKE ALL IMPROVEMENTS IN THE FIELD FOR OWNER'S APPROVAL PRIOR TO DEMOLITION OR EARTHWORK.
  2. THE CONTRACTOR SHALL STAKE THE PLAYGROUND AND THE WHEELCHAIR RAMP IN THE FIELD FOR OWNER'S APPROVAL, BEFORE EARTHWORK OR DEMOLITION.
  3. CONTRACTOR SHALL WASHOUT CONCRETE RELATED EQUIPMENT OFFSITE OR USING A 6' X8' X12' CONCRETE WASHOUT BIN ON SITE. DO NOT WASHOUT CONCRETE RELATED EQUIPMENT ON SITE WITHOUT THE WASHOUT BIN.
  4. STORMWATER SIDE SERVICE: CONTACT PUBLIC WORKS DEPARTMENT FOR INSPECTION. ALL OTHER WORK CONTACT PARKS AND RECREATION INSPECTOR.
  5. INSTALL CONSTRUCTION FENCE AS SHOWN ON THE COVER SHEET OF THE PLAN SET.

- LEGEND
- EXISTING STORM DRAIN LINE
  - FIRE HYDRANT
  - IRRIGATION
  - ELECTRICAL METER
  - DRINKING FOUNTAIN
  - LIGHT

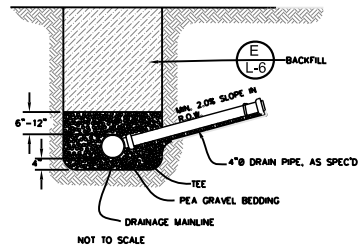
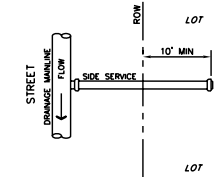

- NOTES:
1. UNLESS OTHERWISE INDICATED ON PLAN, SIDE SERVICE SHALL BE LOWER THAN THE LOWEST LOT ELEVATION.
  2. WHEN REPLACING EXISTING SIDE SERVICE, CONTRACTOR SHALL VERIFY POSITIVE FALL, OTHER EXISTING CONNECTIONS, AND SAGS OR DEFLECTIONS IN PIPE, AS PER ASTM F 1743 8.6.

**E** STORM DRAIN CONNECTION  
L-6 N.T.S.

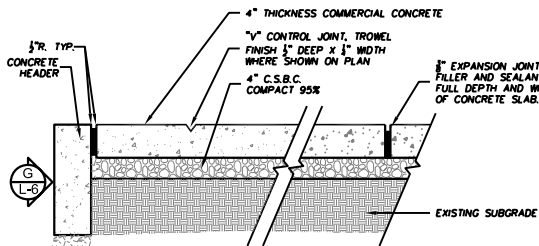

**F** CONCRETE PAVING  
L-6 N.T.S.

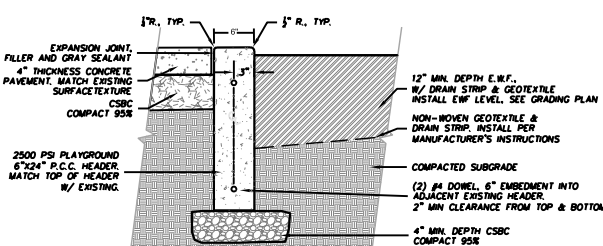

**G** PAVEMENT-HEADER-PATCH  
L-6 N.T.S.

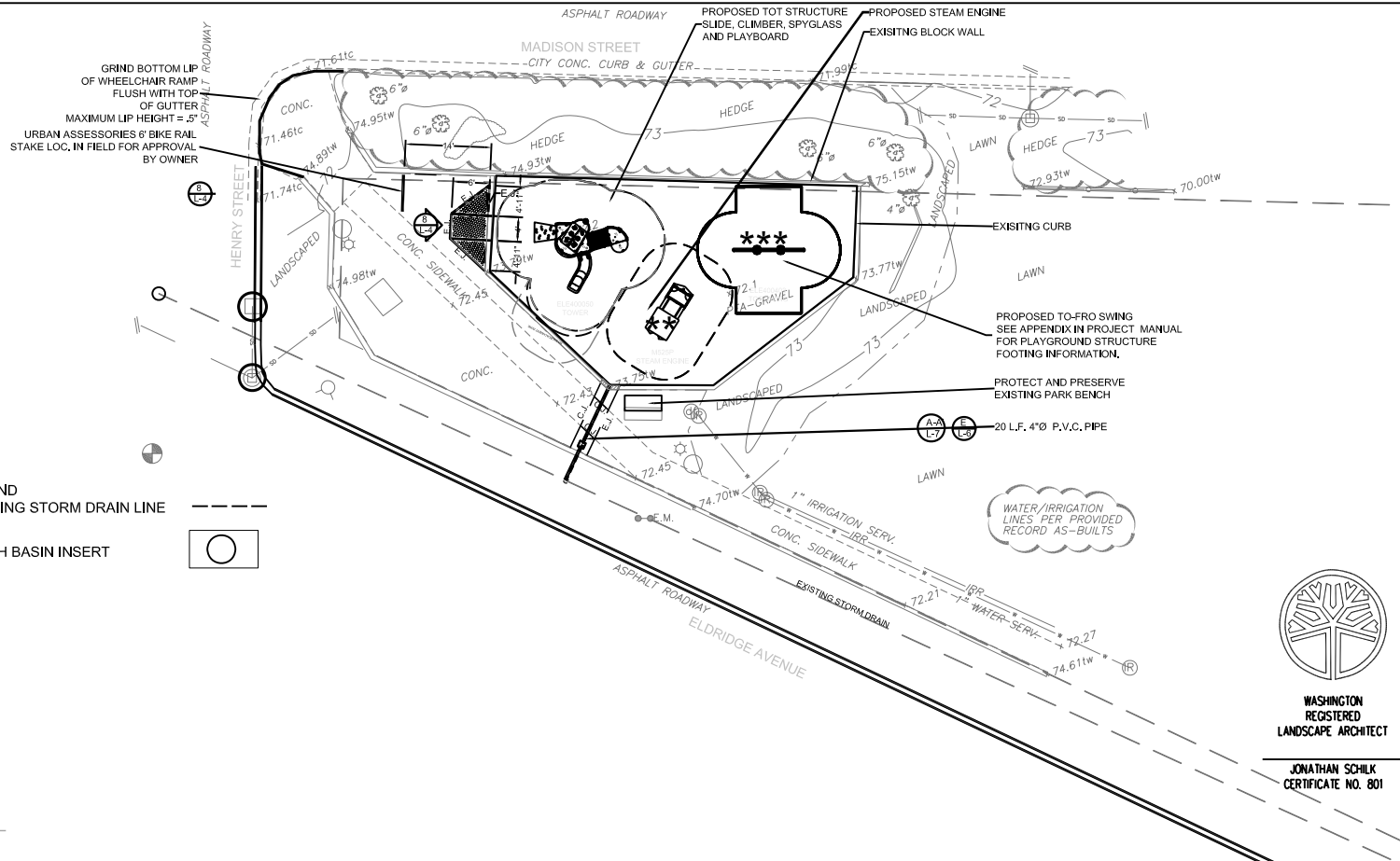

- LEGEND
- EXISTING STORM DRAIN LINE
  - CATCH BASIN INSERT

- Playground Equipment Legend**
- \* ELE400050 TOWER - Green
  - \*\* ELE525P STEAM ENGINE
  - \*\*\* ELE400403 SWING W/ INFANT SEATS

**BELLINGHAM 2008  
PLAYGROUNDS**



WASHINGTON REGISTERED LANDSCAPE ARCHITECT  
JONATHAN SCHILK  
CERTIFICATE NO. 801

|      |                 |          |                |      |                                 |                  |       |                    |                               |                 |
|------|-----------------|----------|----------------|------|---------------------------------|------------------|-------|--------------------|-------------------------------|-----------------|
| 4    | LANDSCAPE ARCH. | JAS      | DIR. PARKS/REC | P.L. | CITY OF BELLINGHAM, WASHINGTON  | SCALE            | DATUM | Job. No. PD2027-1C | CARL LOBE PARK TOT LOT LAYOUT | SHEET L-6 OF 10 |
| 3    | DESIGNED/DRAWN  | JAS      | D & D MANAGER  | L.B. | PARKS AND RECREATION DEPARTMENT | Horiz. 1"=10'-0" | CITY  | Date 4/30/2007     |                               |                 |
| 2    | INSPECTOR       | SPW      |                |      | DESIGN AND DEVELOPMENT DIVISION | Vert. N/A        |       | Field Bk. N/A      |                               |                 |
| Date | No.             | Revision | By             |      |                                 |                  |       |                    |                               |                 |



