



Granary Avenue and Laurel Street

Project Overview: WF-1011

Construction of two new arterial streets in the Downtown Waterfront portion of the former Georgia Pacific mill site. This project includes new public and franchise utilities, bicycle and pedestrian facilities, parking, landscaping and street lighting. Granary Avenue connects to Roeder Ave just south of the Granary Building and Laurel Street connects to Cornwall Avenue.

This project provides public access through the waterfront area and connects to a new [public park](#) along the Whatcom Waterway. By providing access and utilities through the site, the project also allows for mixed-use development within the Waterfront sub-area.

The site is a former industrial area and the new facilities will be constructed over an environmental clean-up. The railway adjacent to the site also requires coordination for utility and street crossings.

Project is being funded by the Federal Highway Administration, Whatcom County EDI, and City of Bellingham Street Fund.

Project Drawings

- [Proposed Street Sections](#)
- [Proposed Street Alignment](#)

Status

Accomplishments: Construction completed July 2019.

- Status - Under Construction
- Contract Awarded - October 9, 2017
- Contract Amount - \$8,600,000
- Contractor - Ram Construction, Inc.
- Completion Date: July 2019
- Final Contract Amount:
- [Vicinity Map](#)
- [Live Web Cam](#)

Affected Neighborhoods

- City Center

Participating Departments

- Public Works

contacts

Freeman Anthony, P.E.
Project Engineer
Phone: (360) 778-7924

[Public Works Contacts](#)

City of Bellingham
WF-1011
Granary - Laurel Avenue

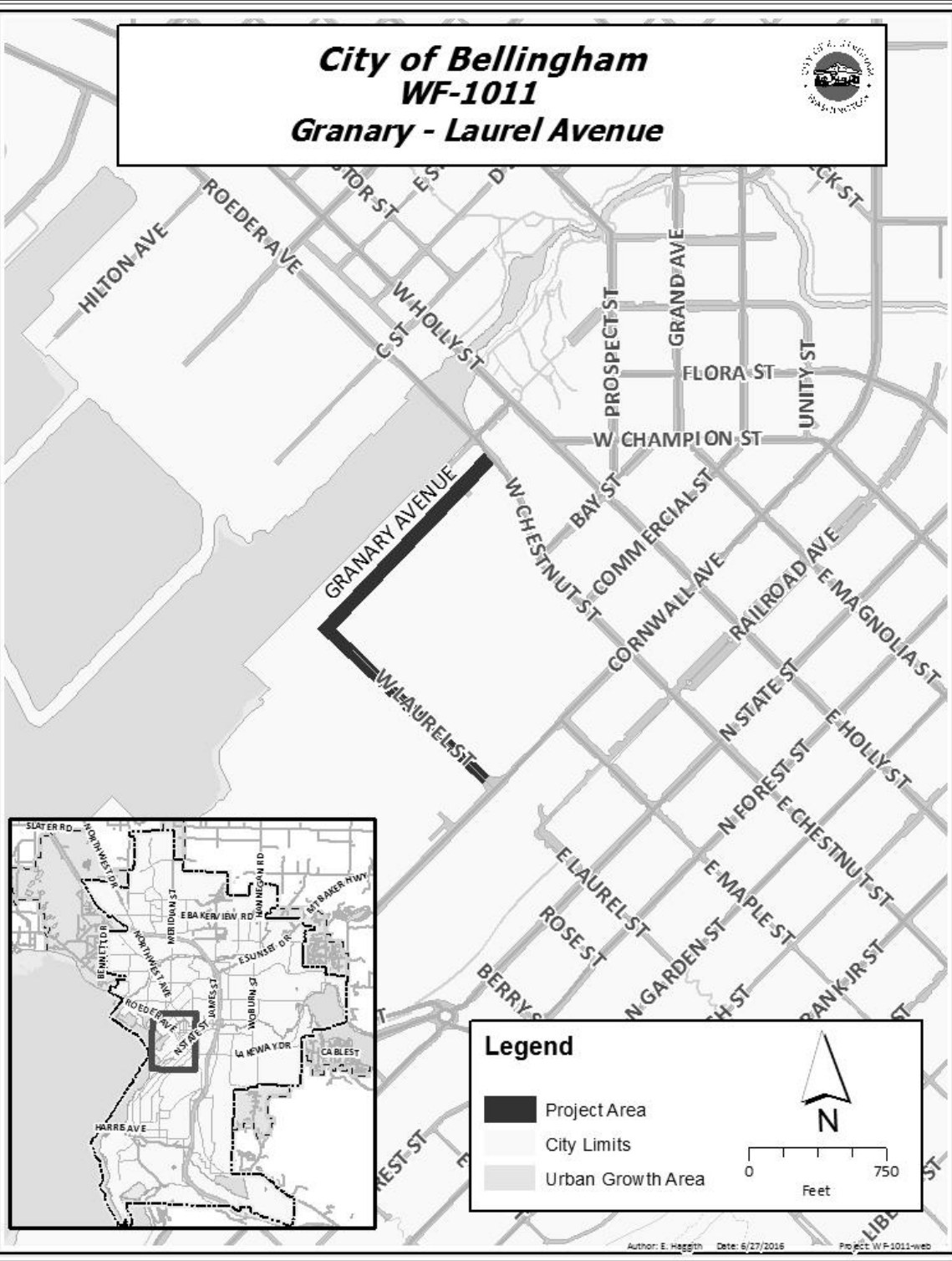

2-WAY CYCLE TRACK ALTERNATIVE

GRANARY AVENUE

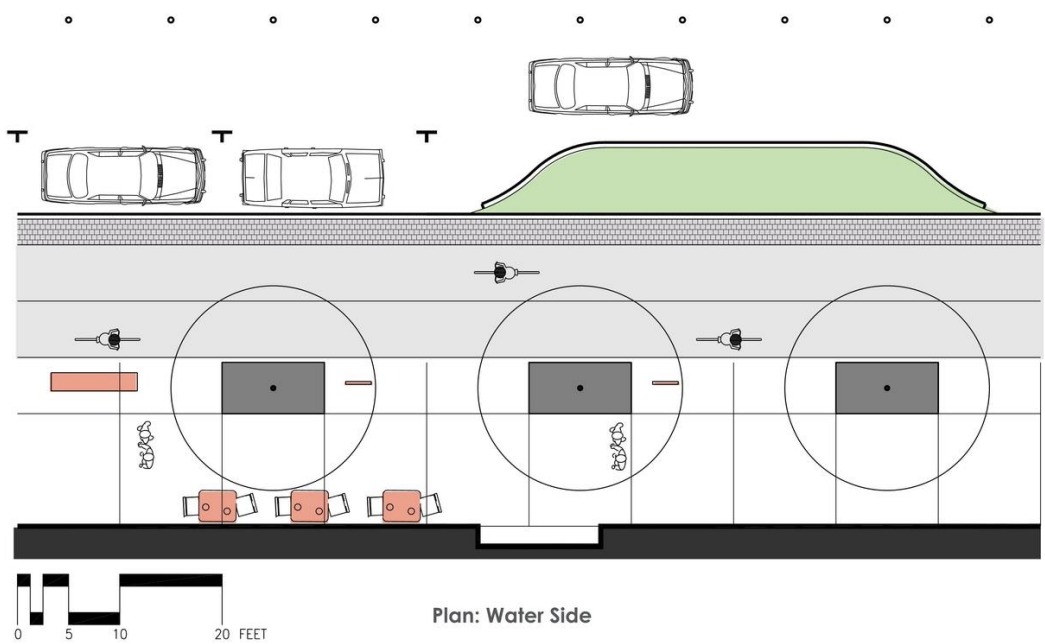
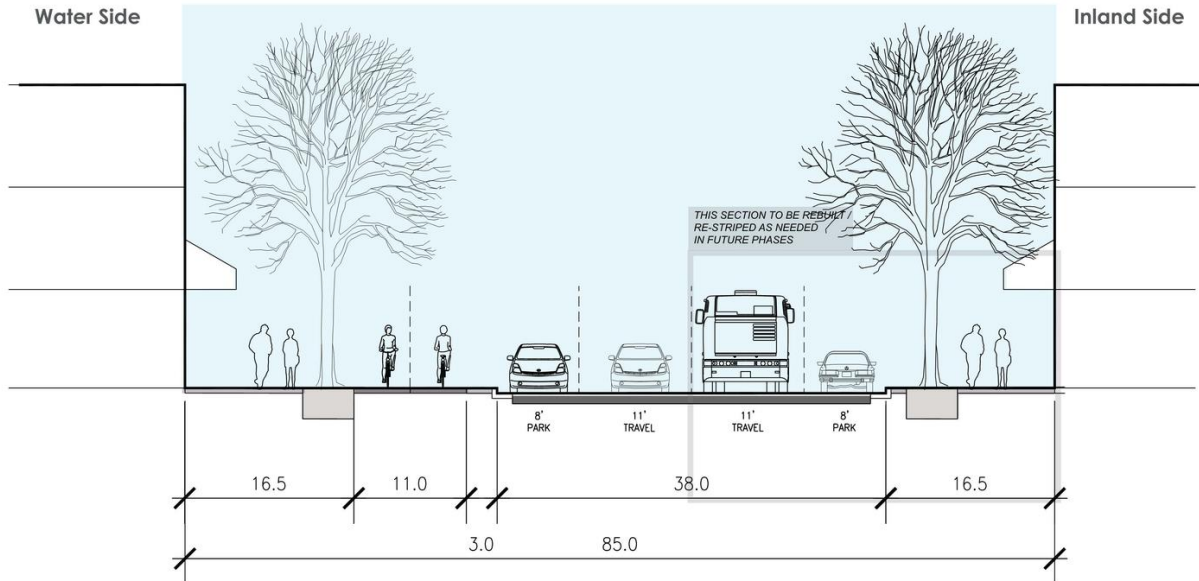

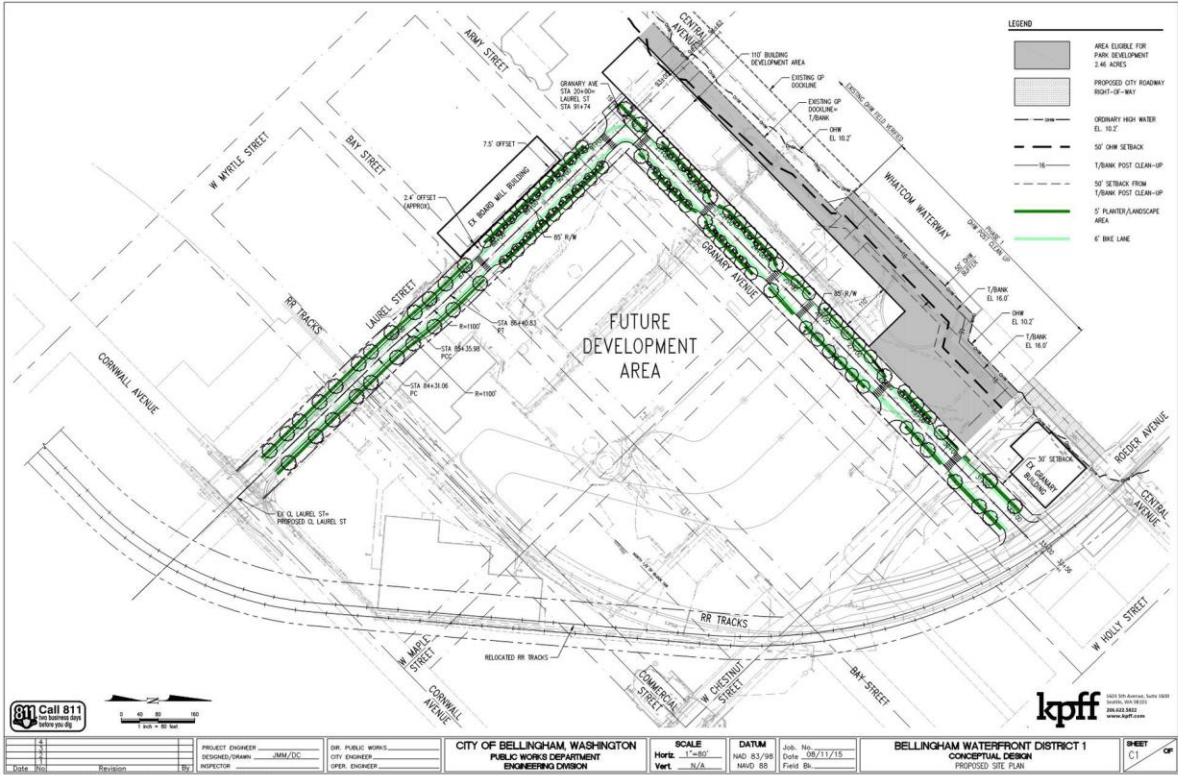

811 Call Center
 1-800-855-8111
 www.kpff.com

Call 811
 for more information
 visit us online

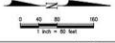

1	2	3	4
DATE	REVISION	BY	PROJECT ENGINEER
			DESIGNED/DRAWN: JNM/DC
			CITY ENGINEER
			OPER. ENGINEER

MR. PUBLIC WORKS
 CITY ENGINEER
 OPER. ENGINEER

CITY OF BELLINGHAM, WASHINGTON
PUBLIC WORKS DEPARTMENT
ENGINEERING DIVISION

SCALE
 Horiz. 1" = 50'
 Vert. N/A

DATUM
 NAD 83/95
 NAVD 88

Job No. 05/11/15
 Date
 Field Bk.

BELLINGHAM WATERFRONT DISTRICT 1
CONCEPTUAL DESIGN
 PROPOSED SITE PLAN

SHEET
 C1 of

CONTACT PERSON: Craig Mueller P.E., PROJECT ENGINEER AT 778-7900

kpff
 1000 5th Avenue, Suite 1000
 Everett, WA 98201
 425.442.8800
 www.kpff.com