

City Engineer

APPROVED
[Signature]

Date

[Signature]

RESIDENTIAL CONCRETE STREET

MINIMUM STANDARD

CITY OF BELLINGHAM

ST-112

DRAWING

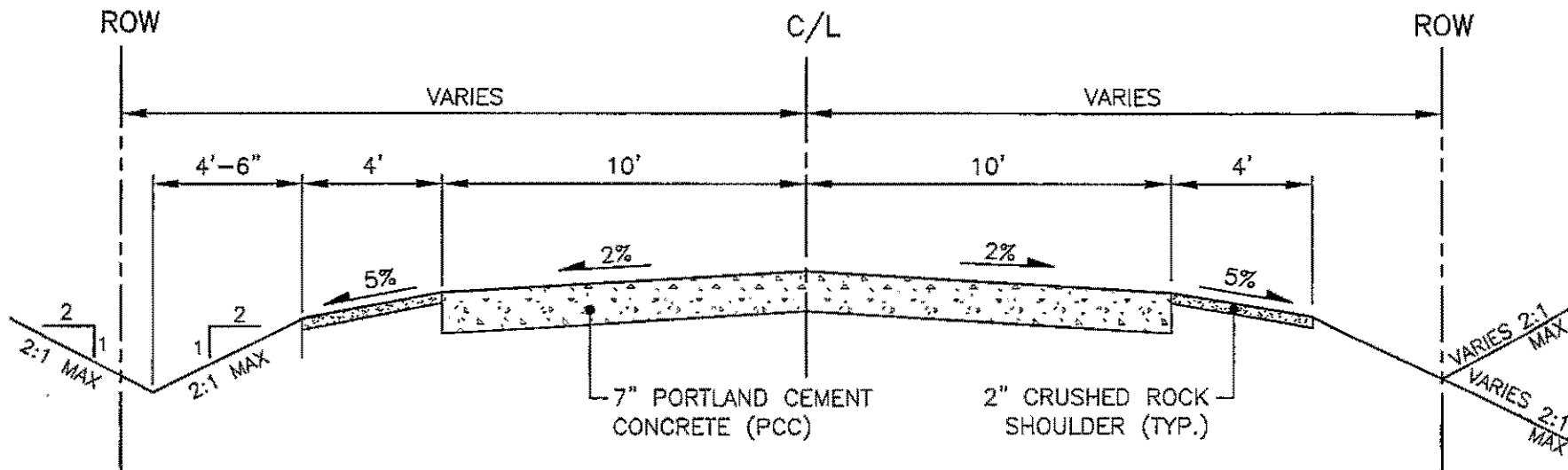

ALTERNATE 'B'

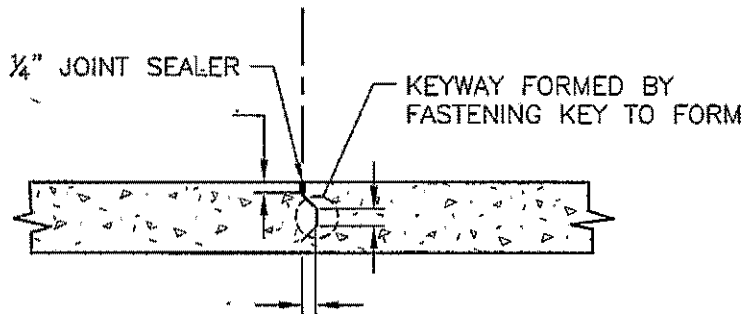

LONGITUDINAL JOINT DETAILS

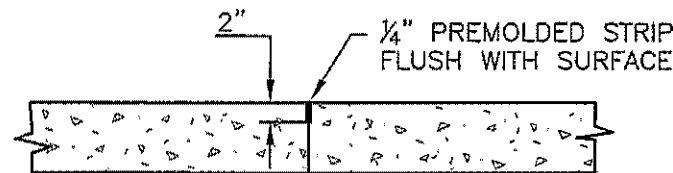

TRANSVERSE JOINT DETAILS

NOTE:

1. CONCRETE SHALL BE 1 1/2" MAXIMUM AGGREGATE SIZE, 5.5 SACK MINIMUM, 5% AIR ENTRAINED WITH A SLUMP OF 1" TO 2 1/2". CONCRETE SHALL HAVE A MODULUS OF RUPTURE OF NOT LESS THAN 550 PSI AT 28 DAYS WHEN TESTED BY THE THIRD POINT LOADING METHOD.
2. TRANSVERSE JOINTS SHALL NOT BE SPACED AT INTERVALS GREATER THAN 12.5 FEET.
3. ALL MATERIAL AND WORKMANSHIP SHALL CONFORM TO THE PROVISIONS OF APPLICABLE SECTIONS OF APWA "STANDARD SPECIFICATIONS" AND SHALL CONFORM TO THE REQUIREMENTS OF THE CITY ENGINEER.